

AERIAL MAP

1 inch = 250 feet

ZC-060-2025
COUNCIL DISTRICT 7
NORTH OF STATE HIGHWAY 255 AND EAST OF FM 1472

APPLICATION FOR
M-1 (LIGHT MANUFACTURING DISTRICT) TO
S.U.P FOR OIL AND/OR GAS EXTRACTIONS (WELL "B" SITE)

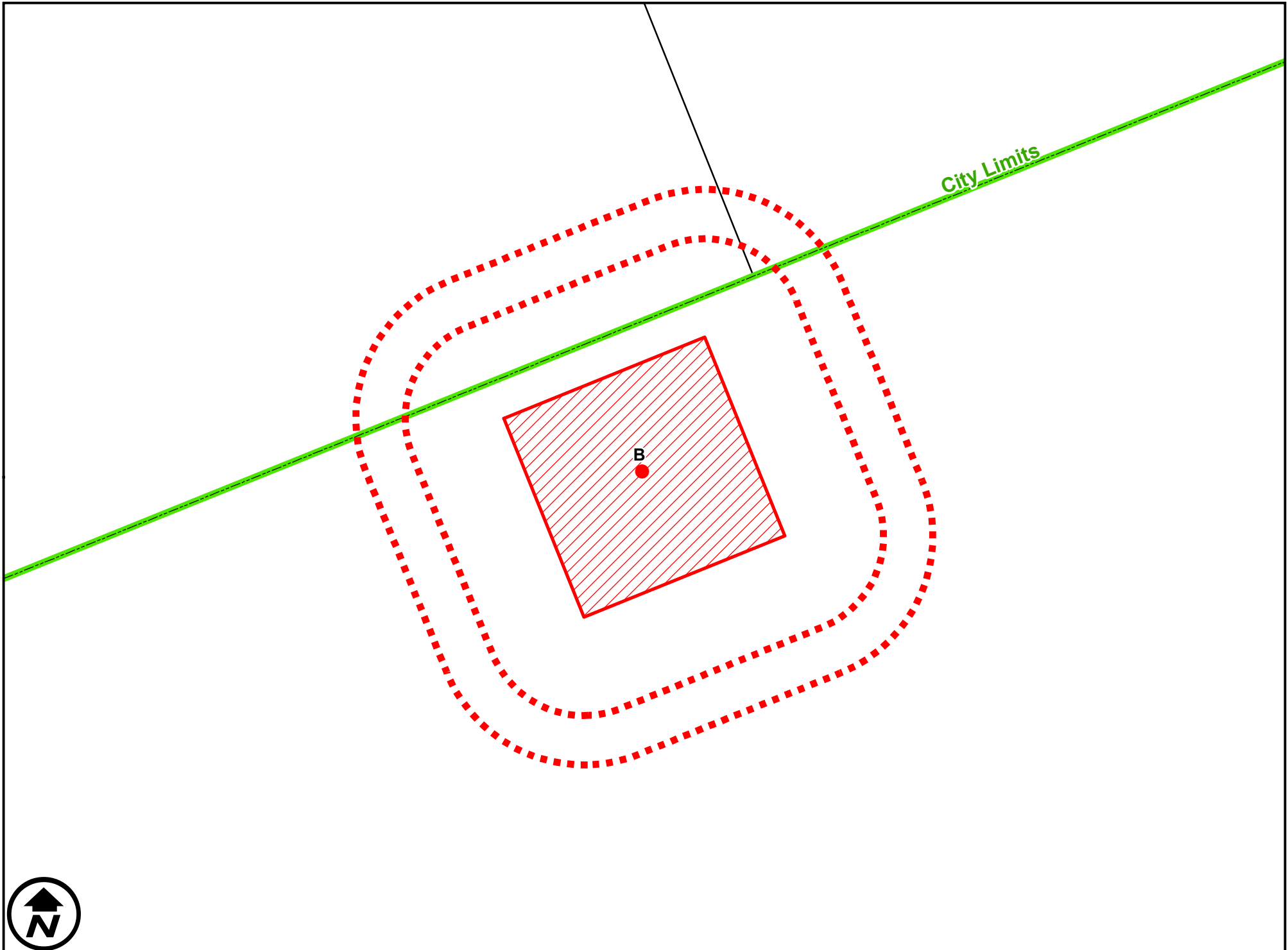

DIMENSIONS MAP

1 inch = 250 feet

ZC-060-2025
COUNCIL DISTRICT 7
NORTH OF STATE HIGHWAY 255 AND EAST OF FM 1472

APPLICATION FOR
M-1 (LIGHT MANUFACTURING DISTRICT) TO
S.U.P FOR OIL AND/OR GAS EXTRACTIONS (WELL "B" SITE)

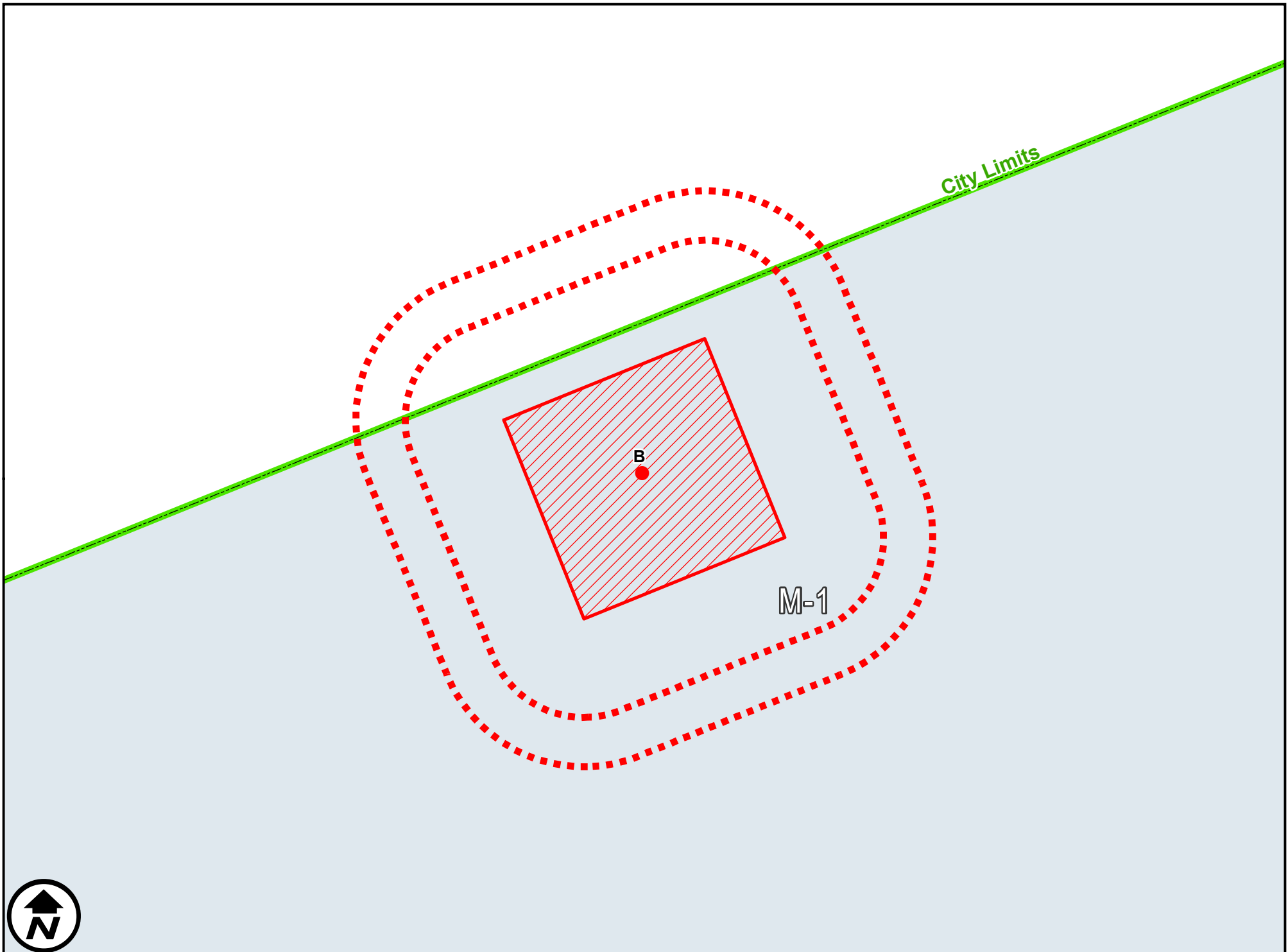

ZONING MAP

1 inch = 250 feet

ZC-060-2025
COUNCIL DISTRICT 7
NORTH OF STATE HIGHWAY 255 AND EAST OF FM 1472

APPLICATION FOR
M-1 (LIGHT MANUFACTURING DISTRICT) TO
S.U.P FOR OIL AND/OR GAS EXTRACTIONS (WELL "B" SITE)

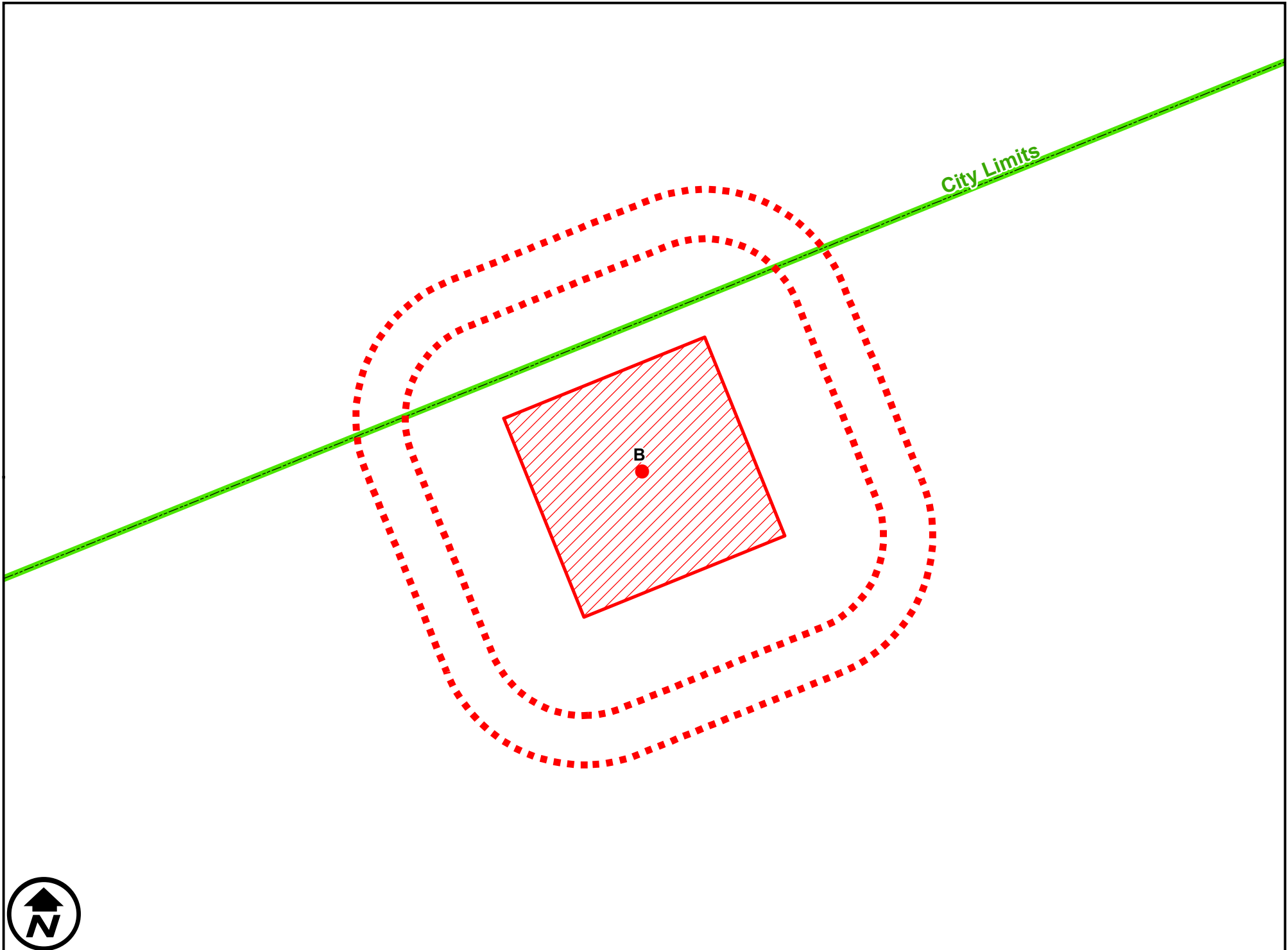

SURVEY MAP

1 inch = 250 feet

ZC-060-2025
COUNCIL DISTRICT 7
NORTH OF STATE HIGHWAY 255 AND EAST OF FM 1472

APPLICATION FOR
M-1 (LIGHT MANUFACTURING DISTRICT) TO
S.U.P FOR OIL AND/OR GAS EXTRACTIONS (WELL "B" SITE)

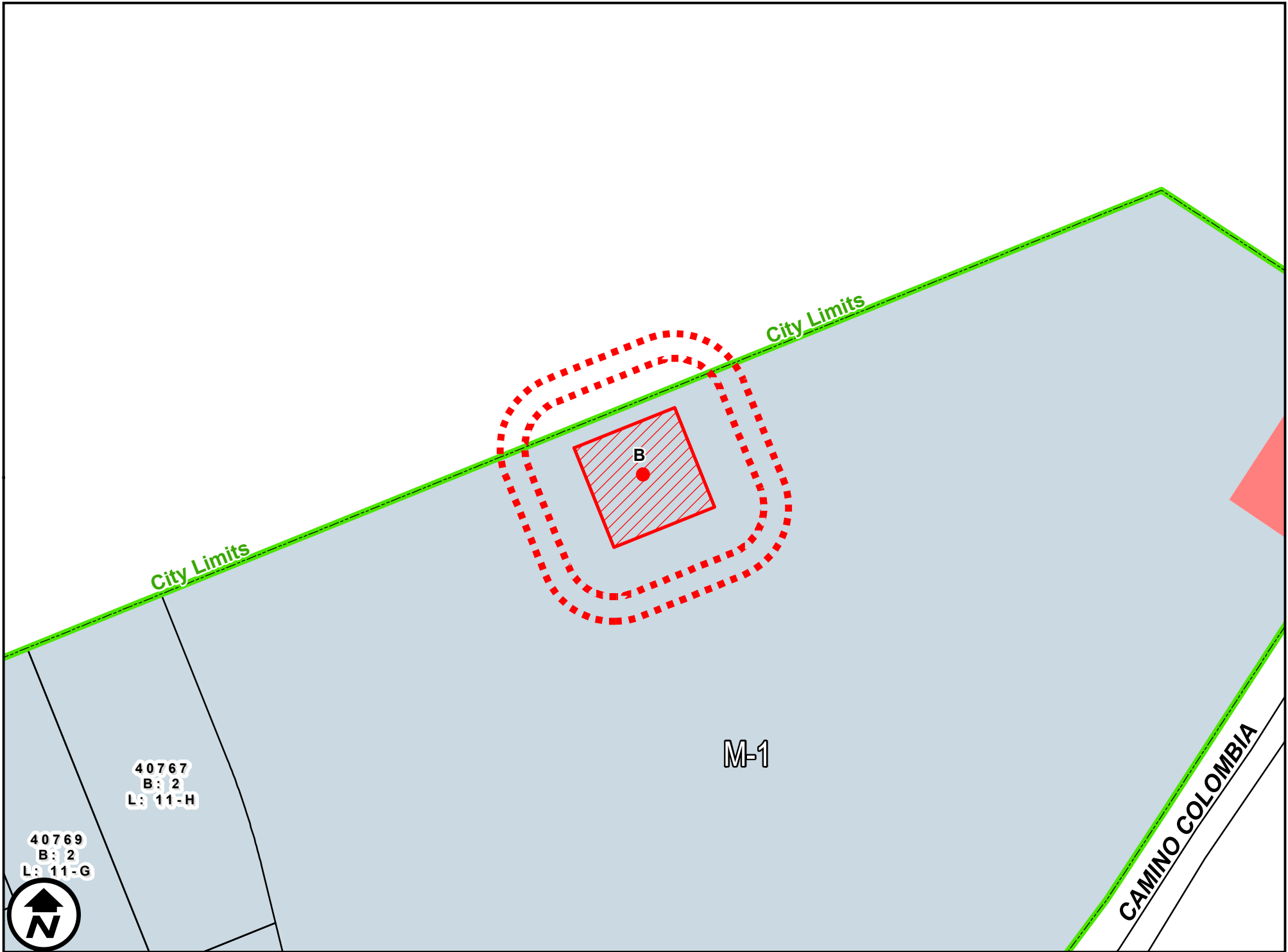

ZONING OVERVIEW

1 inch = 500 feet

ZC-060-2025
COUNCIL DISTRICT 7
NORTH OF STATE HIGHWAY 255 AND EAST OF FM 1472

APPLICATION FOR
M-1 (LIGHT MANUFACTURING DISTRICT) TO
S.U.P FOR OIL AND/OR GAS EXTRACTIONS (WELL "B" SITE)

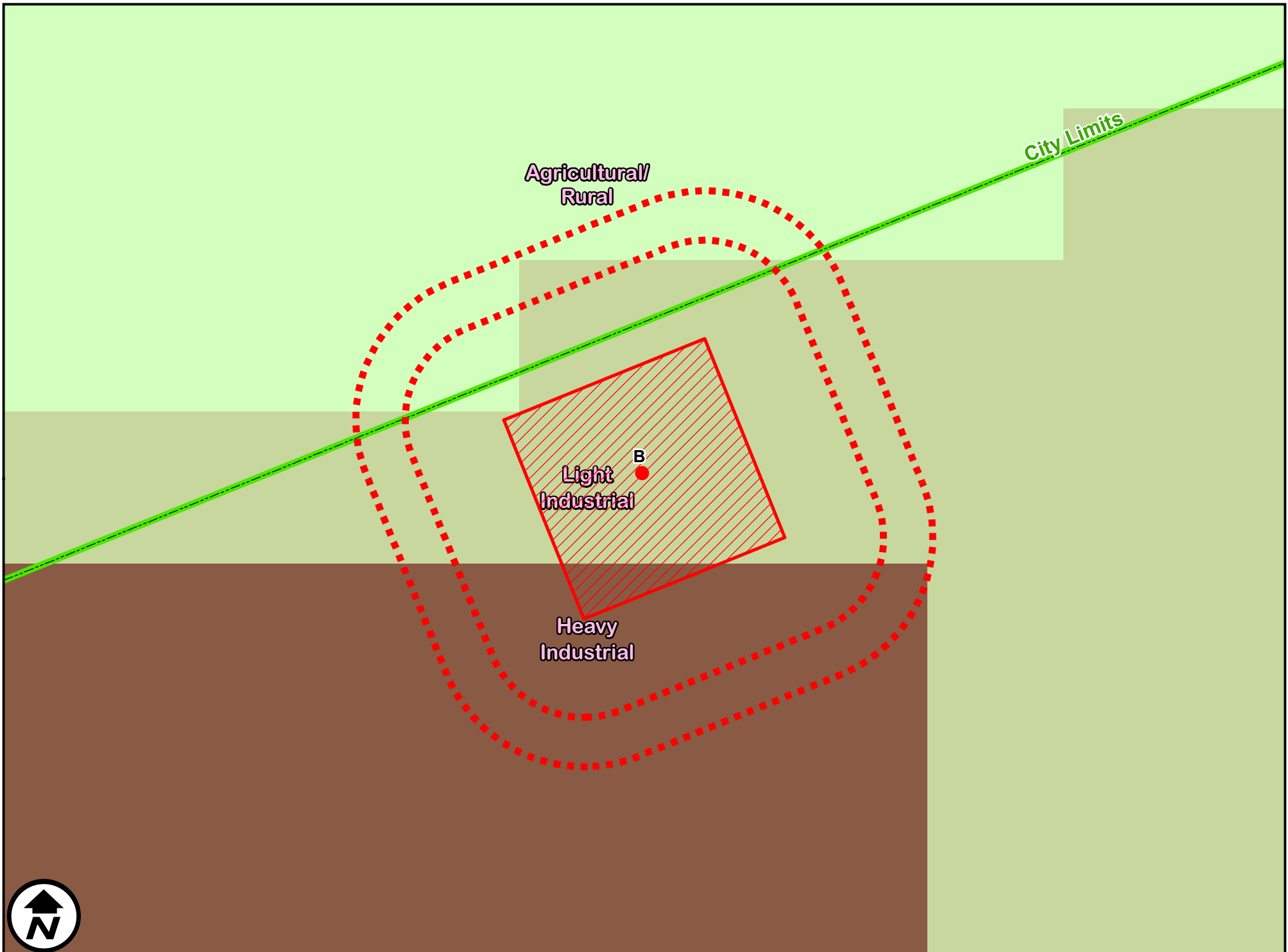

FUTURE LANDUSE

1 inch = 250 feet

ZC-060-2025
COUNCIL DISTRICT 7
NORTH OF STATE HIGHWAY 255 AND EAST OF FM 1472

APPLICATION FOR
M-1 (LIGHT MANUFACTURING DISTRICT) TO
S.U.P FOR OIL AND/OR GAS EXTRACTIONS (WELL "B" SITE)

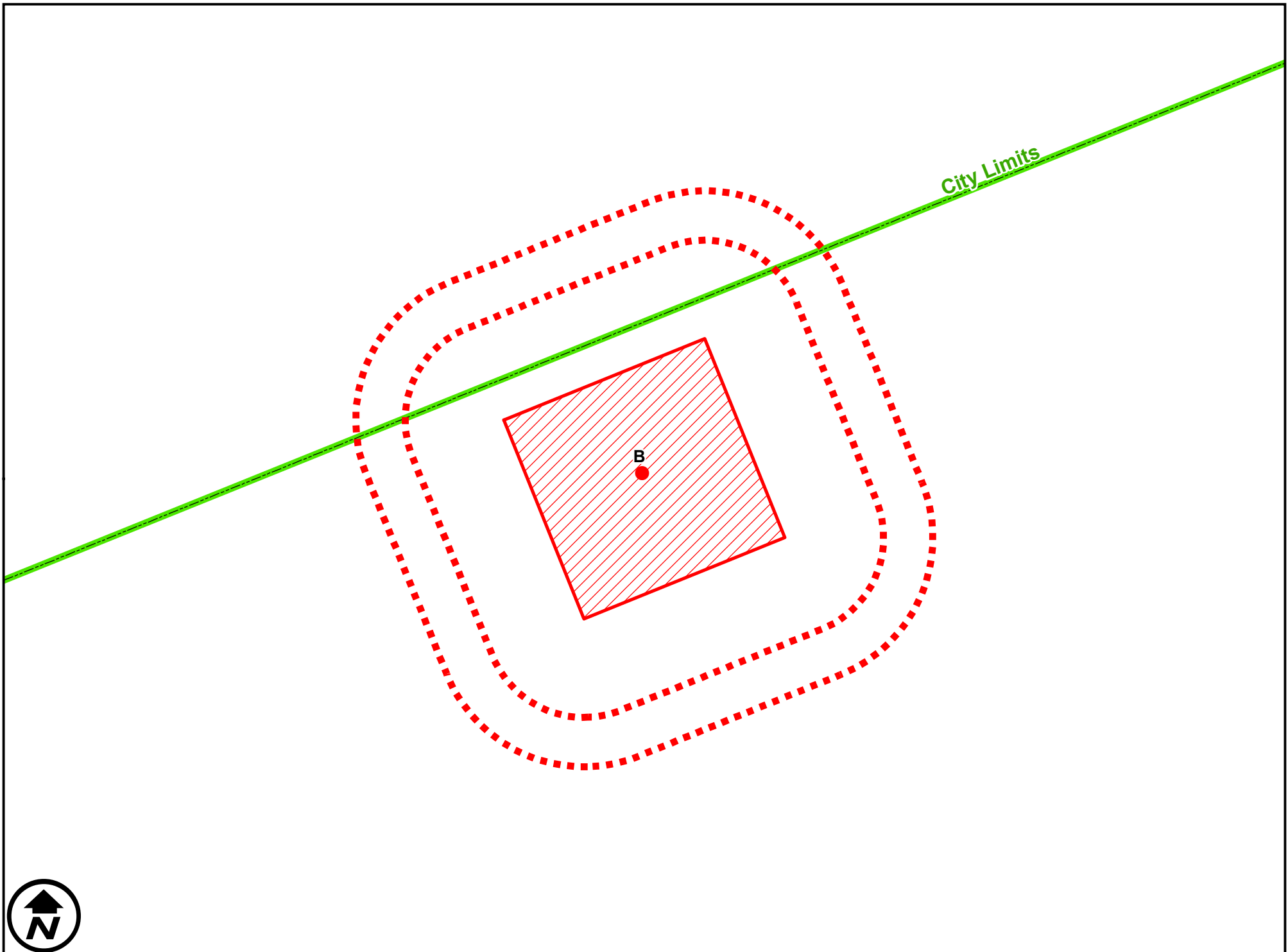



AERIAL MAP

1 inch = 2,000 feet

COUNCIL DISTRICT 7
NORTH OF STATE HIGHWAY 255 AND EAST OF FM 1472

APPLICATION FOR
M-1 (LIGHT MANUFACTURING DISTRICT) TO
S.U.P FOR OIL AND/OR GAS EXTRACTIONS (WELLS "A" AND "B" SITE)

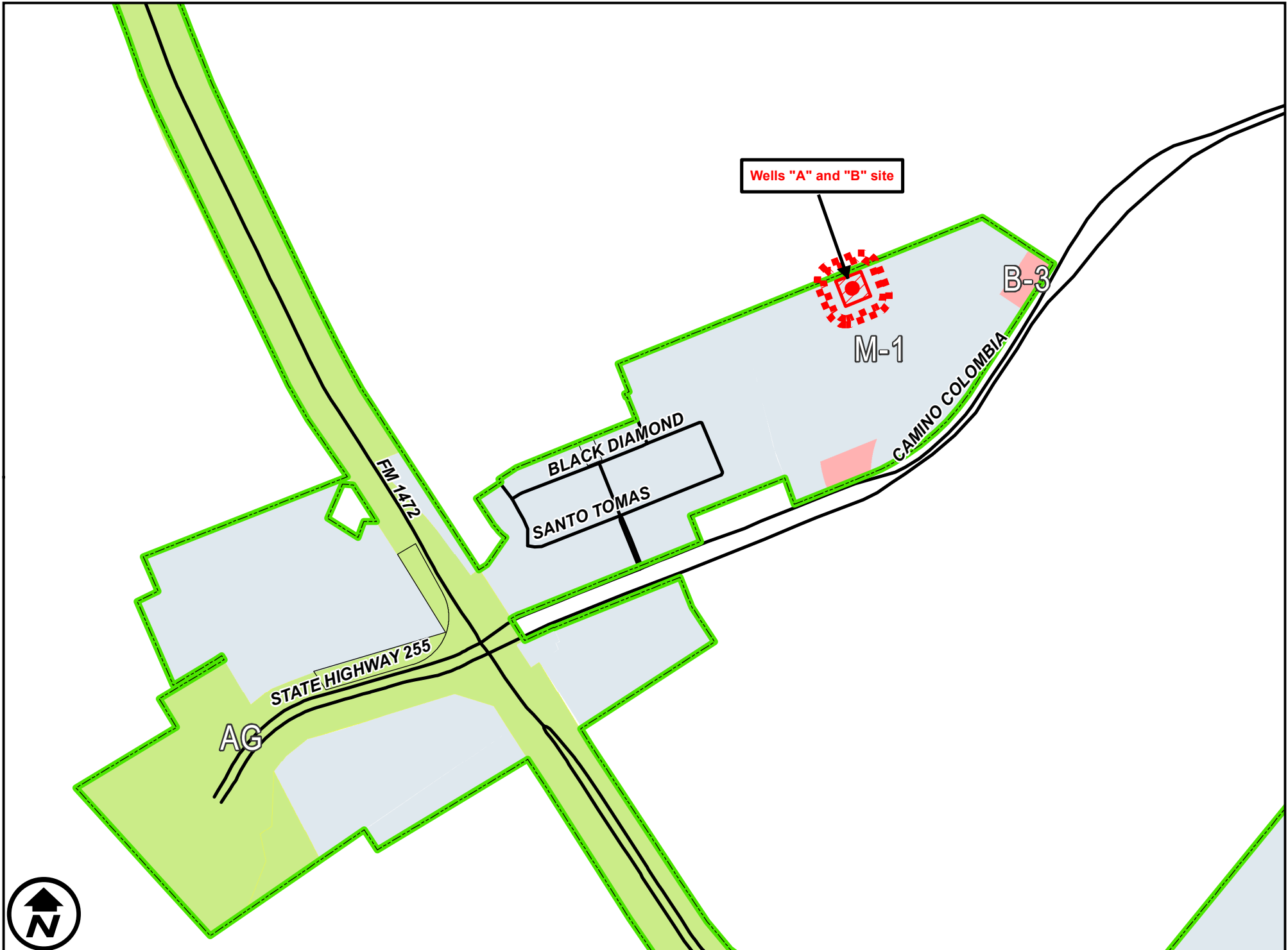

ZONING MAP

1 inch = 2,000 feet

COUNCIL DISTRICT 7
NORTH OF STATE HIGHWAY 255 AND EAST OF FM 1472

APPLICATION FOR
M-1 (LIGHT MANUFACTURING DISTRICT) TO
S.U.P FOR OIL AND/OR GAS EXTRACTATIONS (WELLS "A" AND "B" SITE)

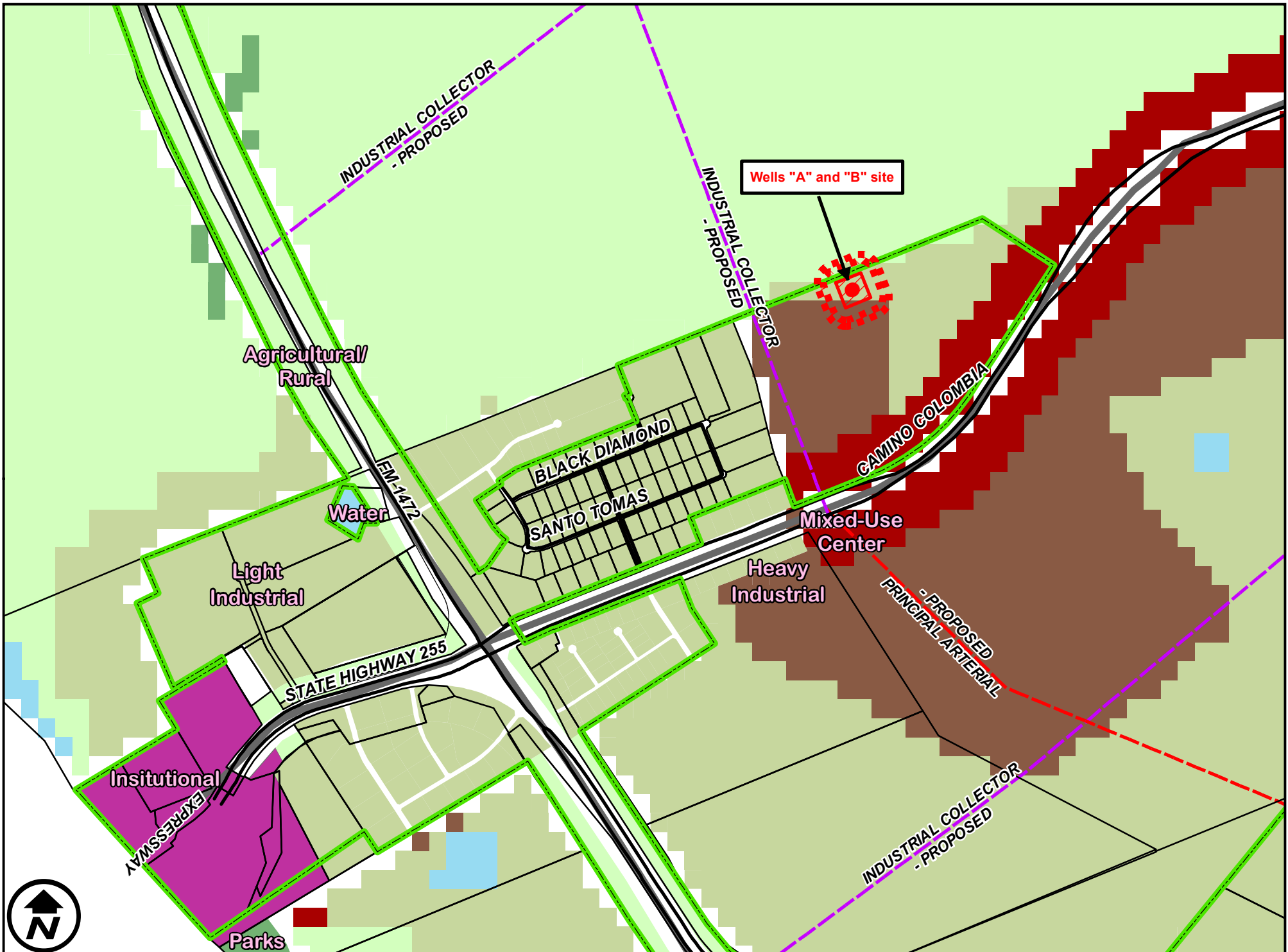

FUTURE LANDUSE

1 inch = 2,000 feet

COUNCIL DISTRICT 7
NORTH OF STATE HIGHWAY 255 AND EAST OF FM 1472

APPLICATION FOR
M-1 (LIGHT MANUFACTURING DISTRICT) TO
S.U.P FOR OIL AND/OR GAS EXTRACTIONS (WELLS "A" AND "B" SITE)