

AERIAL MAP

1 inch = 250 feet

ZC-059-2025
COUNCIL DISTRICT 7
NORTH OF STATE HIGHWAY 255 AND EAST OF FM 1472

APPLICATION FOR
M-1 (LIGHT MANUFACTURING DISTRICT) TO
S.U.P FOR OIL AND/OR GAS EXTRACTIONS (WELL "A" SITE)

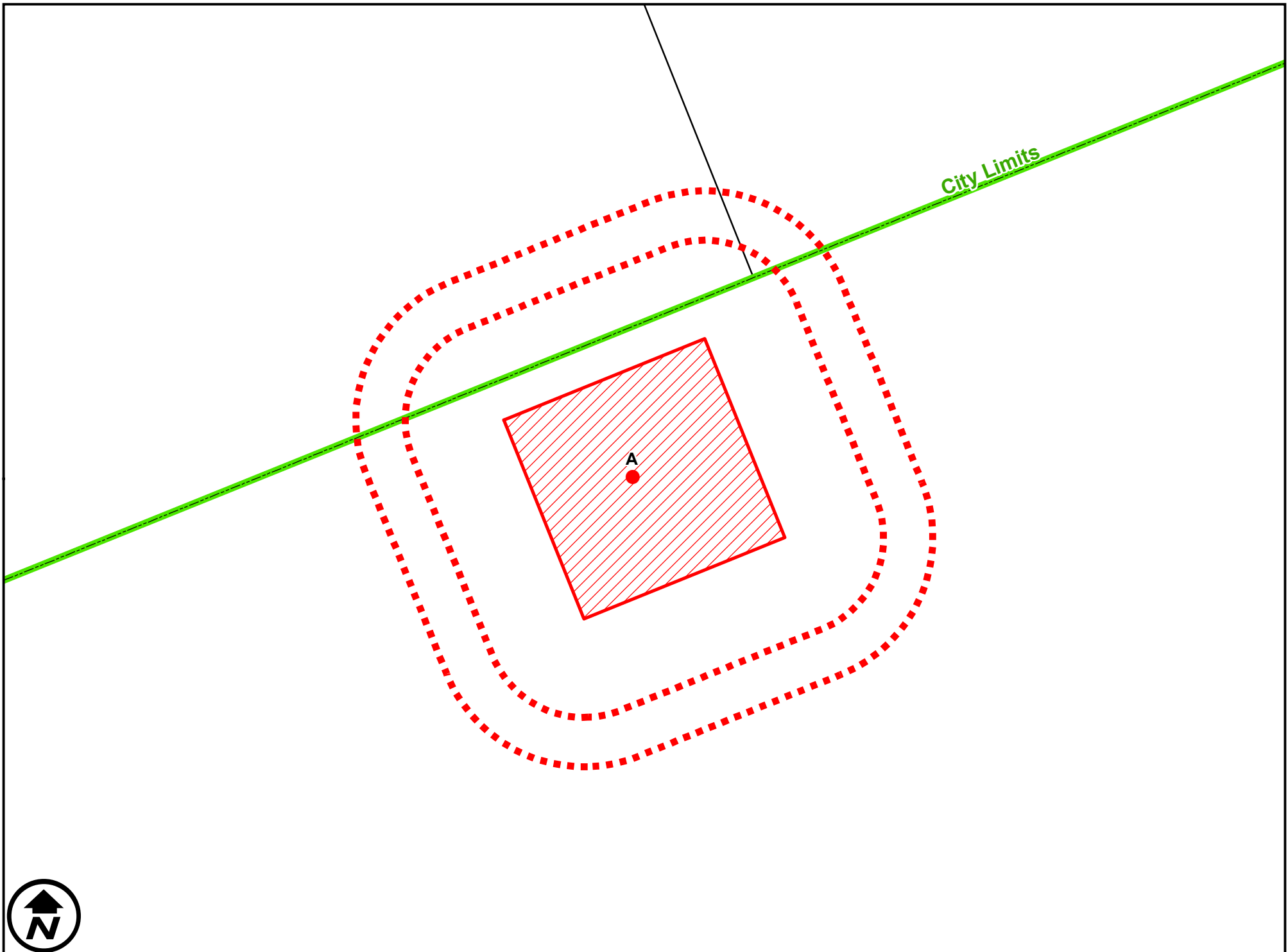

DIMENSIONS MAP

1 inch = 250 feet

ZC-059-2025
COUNCIL DISTRICT 7
NORTH OF STATE HIGHWAY 255 AND EAST OF FM 1472

APPLICATION FOR
M-1 (LIGHT MANUFACTURING DISTRICT) TO
S.U.P FOR OIL AND/OR GAS EXTRACTIONS (WELL "A" SITE)

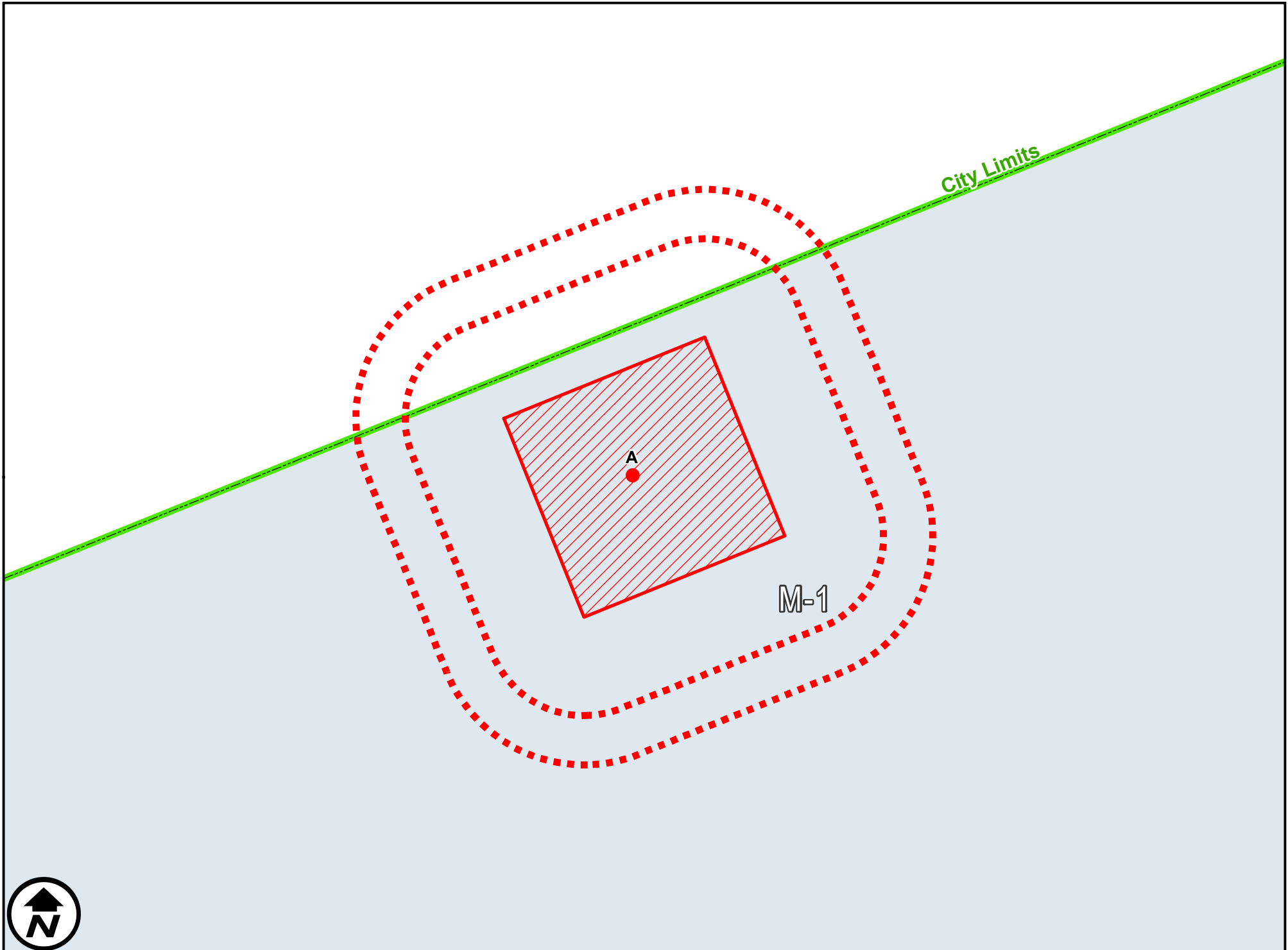

ZONING MAP

1 inch = 250 feet

ZC-059-2025
COUNCIL DISTRICT 7
NORTH OF STATE HIGHWAY 255 AND EAST OF FM 1472

APPLICATION FOR
M-1 (LIGHT MANUFACTURING DISTRICT) TO
S.U.P FOR OIL AND/OR GAS EXTRACTATIONS (WELL "A" SITE)

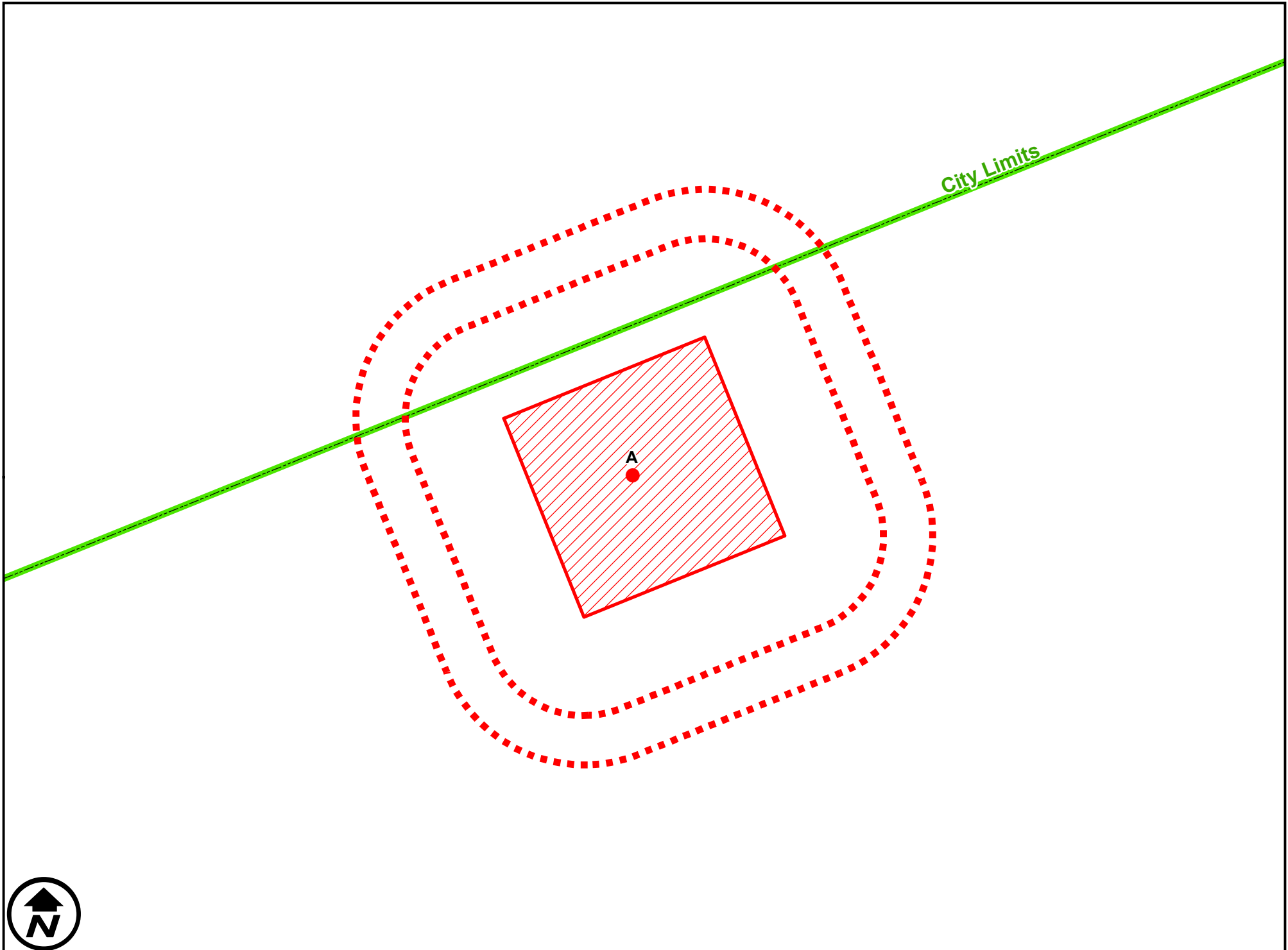

SURVEY MAP

1 inch = 250 feet

ZC-059-2025
COUNCIL DISTRICT 7
NORTH OF STATE HIGHWAY 255 AND EAST OF FM 1472

APPLICATION FOR
M-1 (LIGHT MANUFACTURING DISTRICT) TO
S.U.P FOR OIL AND/OR GAS EXTRACTIONS (WELL "A" SITE)

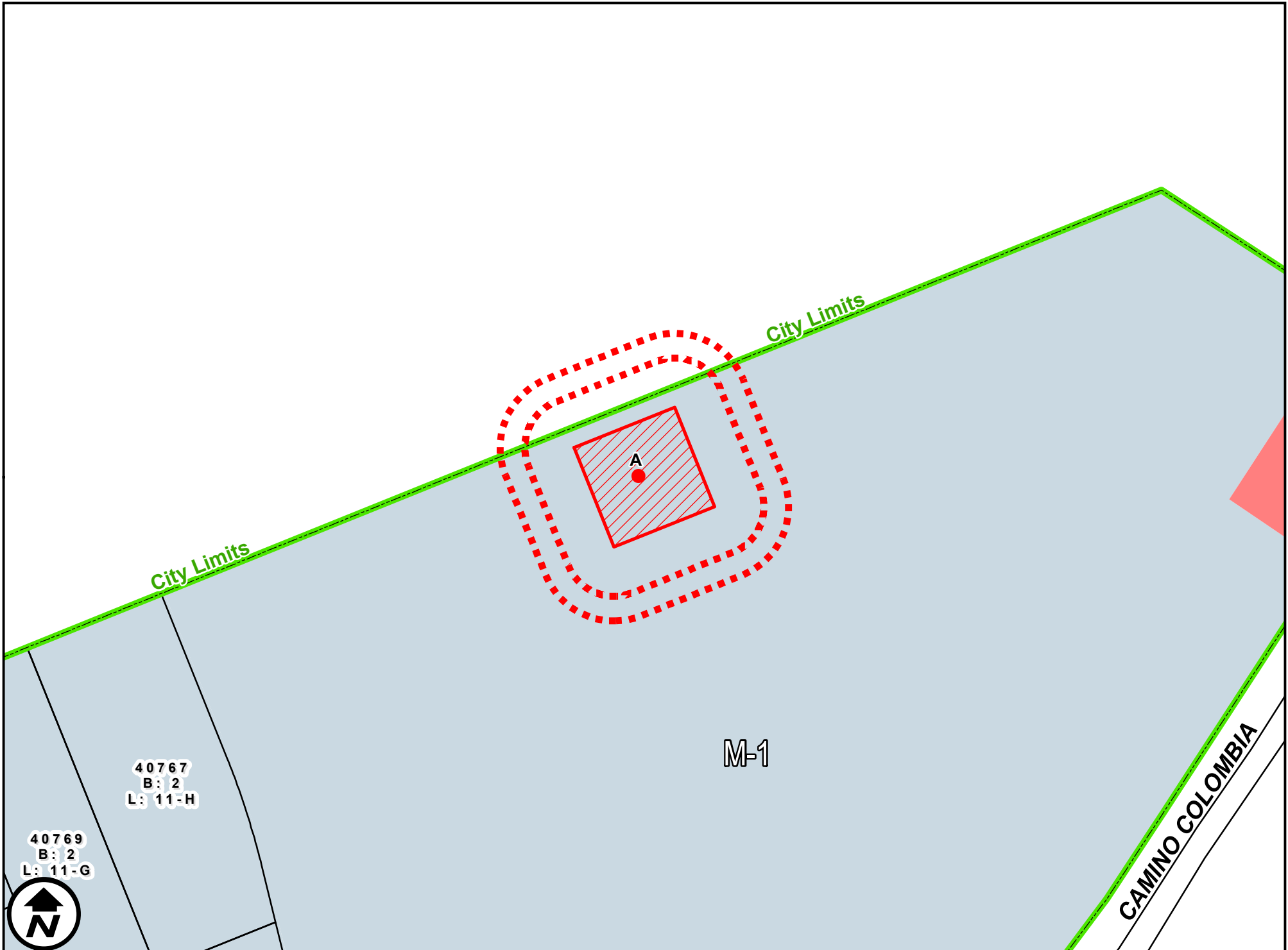

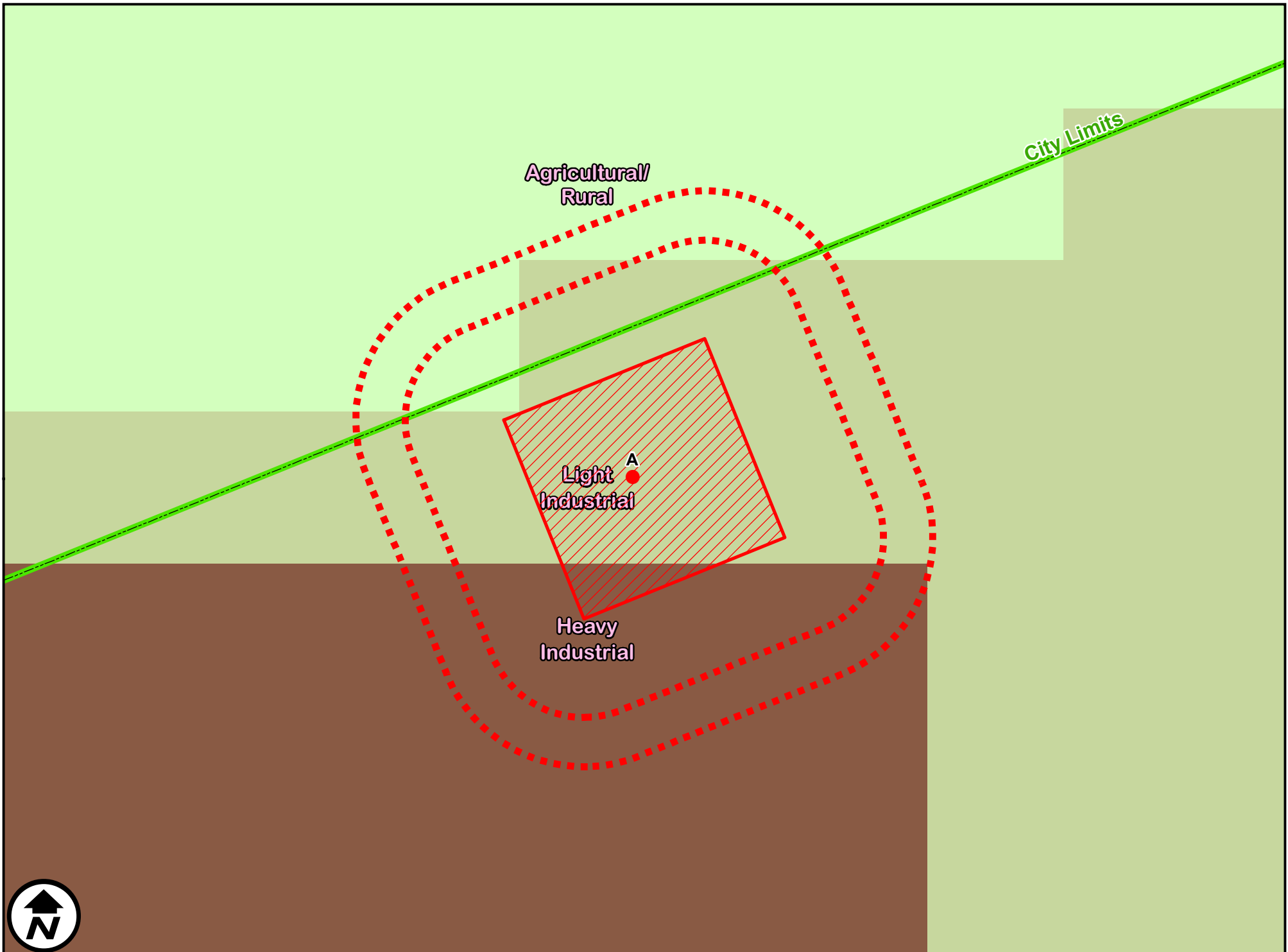

FUTURE LANDUSE

1 inch = 250 feet

ZC-059-2025
COUNCIL DISTRICT 7
NORTH OF STATE HIGHWAY 255 AND EAST OF FM 1472

APPLICATION FOR
M-1 (LIGHT MANUFACTURING DISTRICT) TO
S.U.P FOR OIL AND/OR GAS EXTRACTIONS (WELL "A" SITE)

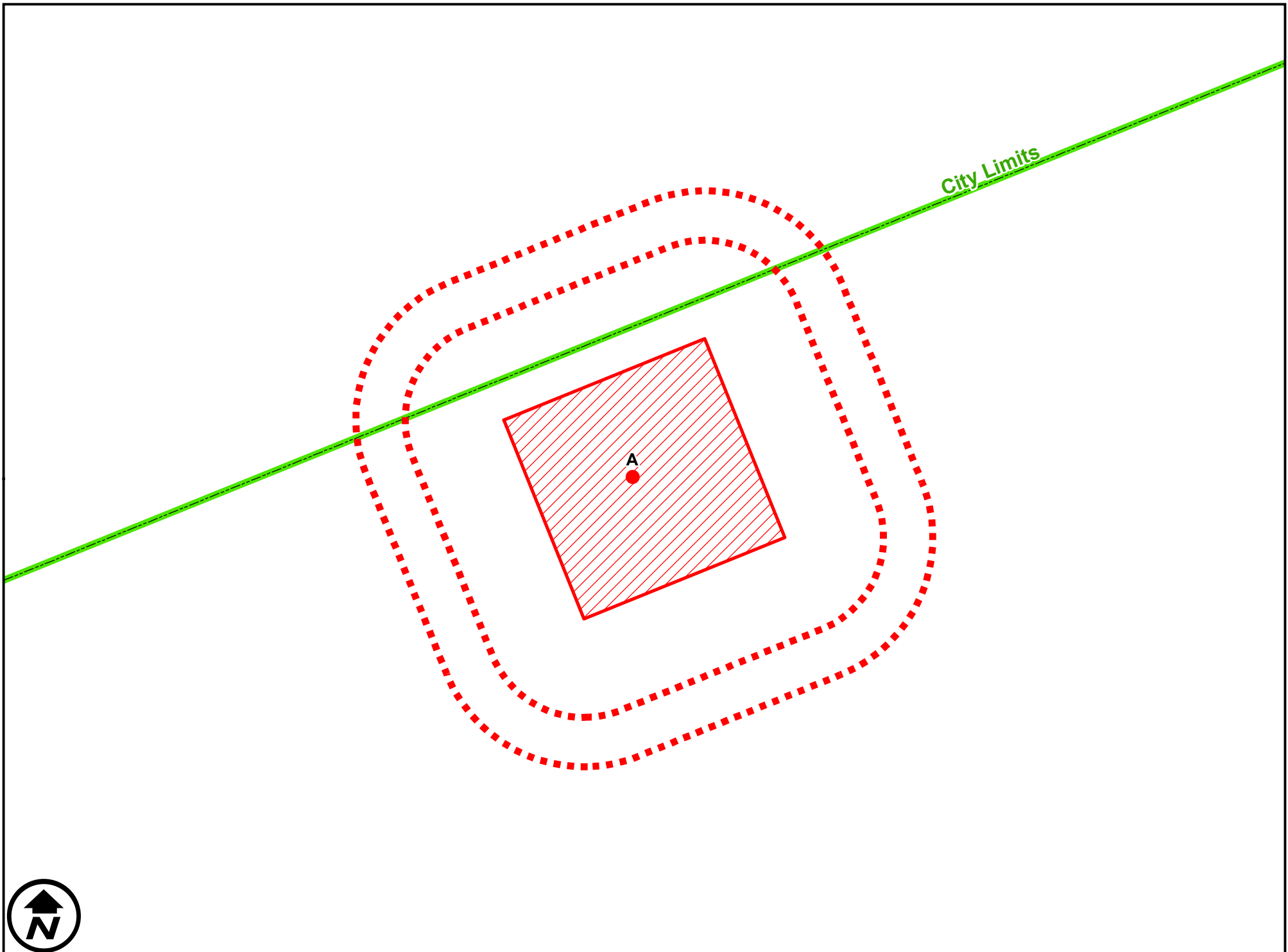

200' AND 300' NOTIFICATION

1 inch = 250 feet

ZC-059-2025
COUNCIL DISTRICT 7
NORTH OF STATE HIGHWAY 255 AND EAST OF FM 1472

APPLICATION FOR
M-1 (LIGHT MANUFACTURING DISTRICT) TO
S.U.P FOR OIL AND/OR GAS EXTRACTIONS (WELL "A" SITE)