

CURRENT APPROVED MASTERPLAN P&Z MEETING OF 4/16/2026

OWNERSHIP TRACTS

- ⊖ MIDCON TEXAS PIPELINE CORP. (OWNER)
- ⊖ SCHLUMBERGER WELL SERVICES, (OWNER)
- ⊖ WHITWORTH HOLDINGS, (OWNER)
- ⊖ MIRACLE CANDLE CO. (OWNER)
- ⊖ LAREDO DISCOUNT METALS CO. (OWNER)
- ⊖ WAL-MART REAL ESTATE BUSINESS TRUST (OWNER)
- ⊖ ELK'S LODGE (OWNER)
- ⊖ AMERICAN ELECTRIC POWER, AEP TCC (OWNER)
- ⊖ MCS CORP. (OWNER)
- ⊖ TARGET CORPORATION (OWNER)

LEGEND

- SFRD** SINGLE FAMILY RESIDENTIAL DISTRICT
- SJMHU** SINGLE FAMILY MANUFACTURED HOUSING
- MFRD** MULTI-FAMILY RESIDENTIAL DISTRICT
- R-OD** RESIDENTIAL - OFFICE DISTRICT
- CBD** COMMERCIAL BUSINESS DISTRICT
- HCD** HIGHWAY COMMERCIAL DISTRICT
- LMD** LIGHT MANUFACTURING DISTRICT

*NOTE
PRESENT WEST END OF KILLEEN DRIVE TO BE
BARRICADED TO PREVENT TRAFFIC FLOW TO PROPOSED
COMMERCIAL AREAS

APPROXIMATE LIMITS OF
100 YEAR FLOOD ZONE
FLOOD INSURANCE RATE MAP
EFFECTIVE DATE: APRIL 8, 2008
COMMUNITY PANEL NO. 480651C 1215

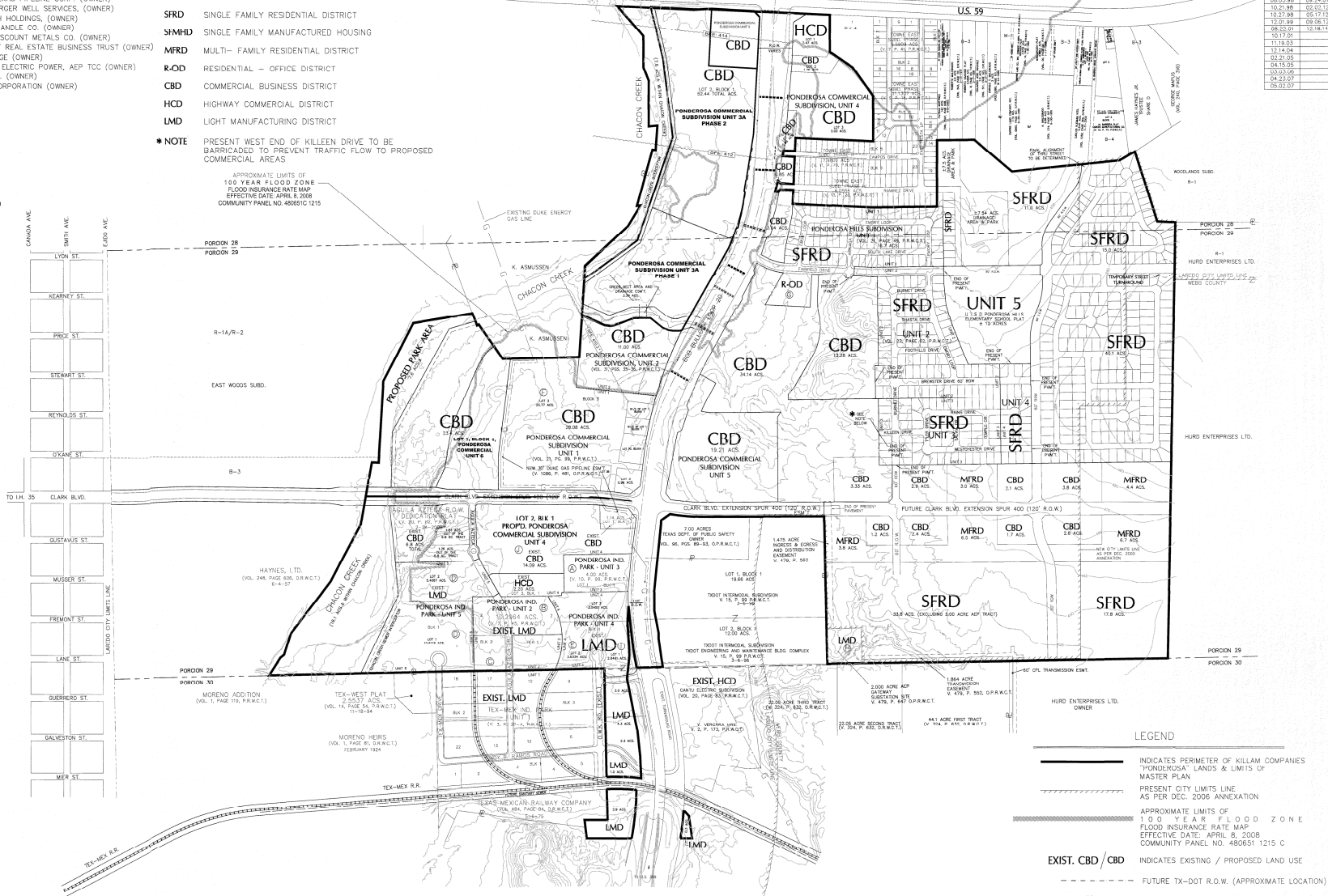
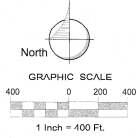

| P&Z APPROVAL DATE | |
|-------------------|----------|
| 04.01.08 | 08.07.07 |
| 04.01.08 | 08.07.07 |
| 08.05.08 | 09.24.07 |
| 10.17.08 | 09.20.07 |
| 10.17.08 | 09.17.07 |
| 10.23.09 | 09.08.07 |
| 08.23.07 | 10.18.14 |
| 10.17.07 | |
| 11.19.03 | |
| 12.14.04 | |
| 02.21.05 | |
| 04.15.05 | |
| 03.21.05 | |
| 04.23.07 | |
| 05.23.07 | |

- ### LEGEND
- INDICATES PERIMETER OF KILLAM COMPANIES "PONDEROSA" LANDS & LIMITS OF MASTER PLAN
 - - - PRESENT CITY LIMITS LINE AS PER DEC. 2006 ANNEXATION
 - APPROXIMATE LIMITS OF 100 YEAR FLOOD ZONE FLOOD INSURANCE RATE MAP EFFECTIVE DATE: APRIL 8, 2008 COMMUNITY PANEL NO. 480651C 1215 C
 - EXIST. CBD / CBD INDICATES EXISTING / PROPOSED LAND USE
 - - - - - FUTURE TX-DOT R.O.W. (APPROXIMATE LOCATION)
 - INDICATES EXISTING NATURAL GROUND CONTOUR LINE (5' INTERVAL) PRIOR TO FINAL CONSTRUCTION
 - BASE FLOOD ELEVATION - F.I.R.M
 - BASE FLOOD ELEVATION INTERPOLATED



City of Laredo, Texas

MESQUITE
LAND USE - MASTER PLAN

PONDEROSA LAND
LAND USE - MASTER PLAN
CITY OF LAREDO, WEBB COUNTY, TEXAS

KILLAM
OWNER:
KILLAM DEVELOPMENT, LTD.
1501 MAZARDIST ST. LAREDO, TEXAS 76041-1904
PHONE: (561) 721-1141

SHEET NAME:
LAND USE - MASTER PLAN

REVISED DATE:

DATE: 04.01.2026

1 OF 1